

GROUP 22A

MANUAL TRANSMISSION

CONTENTS

GENERAL INFORMATION	22A-2	TRANSMISSION CONTROL	22A-4
LUBRICANTS	22A-2	REMOVAL AND INSTALLATION	22A-4
SPECIAL TOOLS.	22A-2	SHIFT AND SELECT CABLE ASSEMBLY .	22A-5
ON-VEHICLE SERVICE.	22A-3	SHIFT KNOB ASSEMBLY.	22A-5
TRANSMISSION OIL LEVEL CHECK	22A-3	TRANSMISSION ASSEMBLY	22A-7
TRANSMISSION OIL REPLACEMENT . . .	22A-3	REMOVAL AND INSTALLATION	22A-7
		TRANSMISSION MOUNT STOPPER.	22A-11

GENERAL INFORMATION

M1222000100379

MANUAL TRANSMISSION MODELS

Transmission model	Combined engine	Vehicle model
F5M51-1-S5P	6G75-S4-MPI	DL1ASN



LUBRICANTS

M1222000400358

Item	Specified lubricant	Quantity (litres)
Transmission oil	Genuine Mitsubishi MTF	2.8

SPECIAL TOOLS

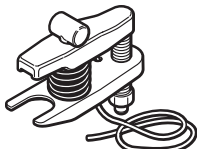
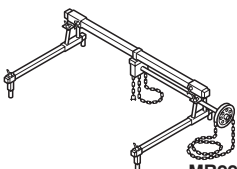
M1222000600396

TOOL	TOOL NUMBER AND NAME	SUPERSESSION	APPLICATION
 AC106827	MB991897 Ball joint remover	MB991113-01 MB990635-01 or General service tool	Knuckle and tie rod end ball joint disconnection
 MB991895	MB991895 Engine hanger	-	When the engine hanger is used: Supporting the engine assembly during removal and installation of the transaxle assembly
 09DB017	MB991460 Plug	-	Preventing foreign substances from entering transmission case

ON-VEHICLE SERVICE

TRANSMISSION OIL LEVEL CHECK

1. Remove the oil filler plug.
2. The oil level should be at the lower portion of the filler plug hole.
3. Check that the transmission oil is not noticeably dirty and that it has suitable viscosity.
4. Tighten the filler plug to specified torque.

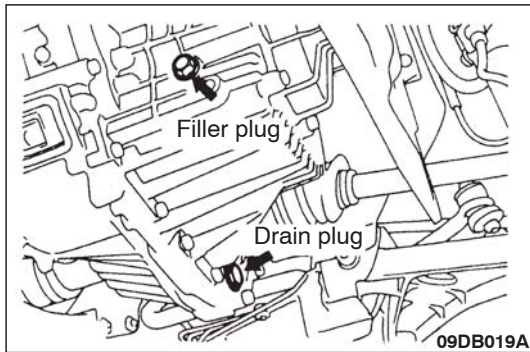
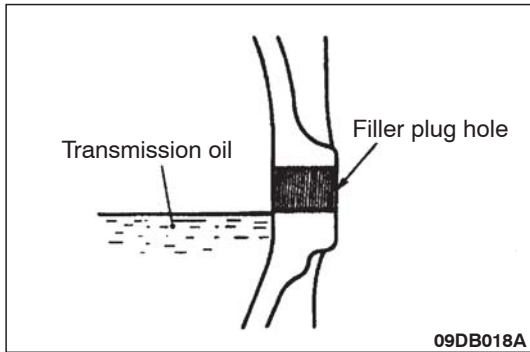

1. Remove the transmission drain plug.
2. Drain oil.
3. Replace and tighten drain plug after draining oil.

Specified torque:

32 Nm

4. Remove filler plug and fill with specified oil until the oil level reaches the lower portion of the filler plug hole.

Transmission oil:

Genuine Mitsubishi MTF

Quantity:

2.8 (litres)

5. Replace and tighten the filler plug to specified torque.

Specified torque:

32 Nm

TRANSMISSION CONTROL

REMOVAL AND INSTALLATION

Pre-removal Operation

- Air Cleaner Removal (Refer to GROUP 15, Air Cleaner 15-4).
- Battery and Battery Tray Removal

CAUTION

SRS

Be careful not to subject the SRS-ECU to any shocks during removal and installation of the transmission control cable and shift lever assembly.

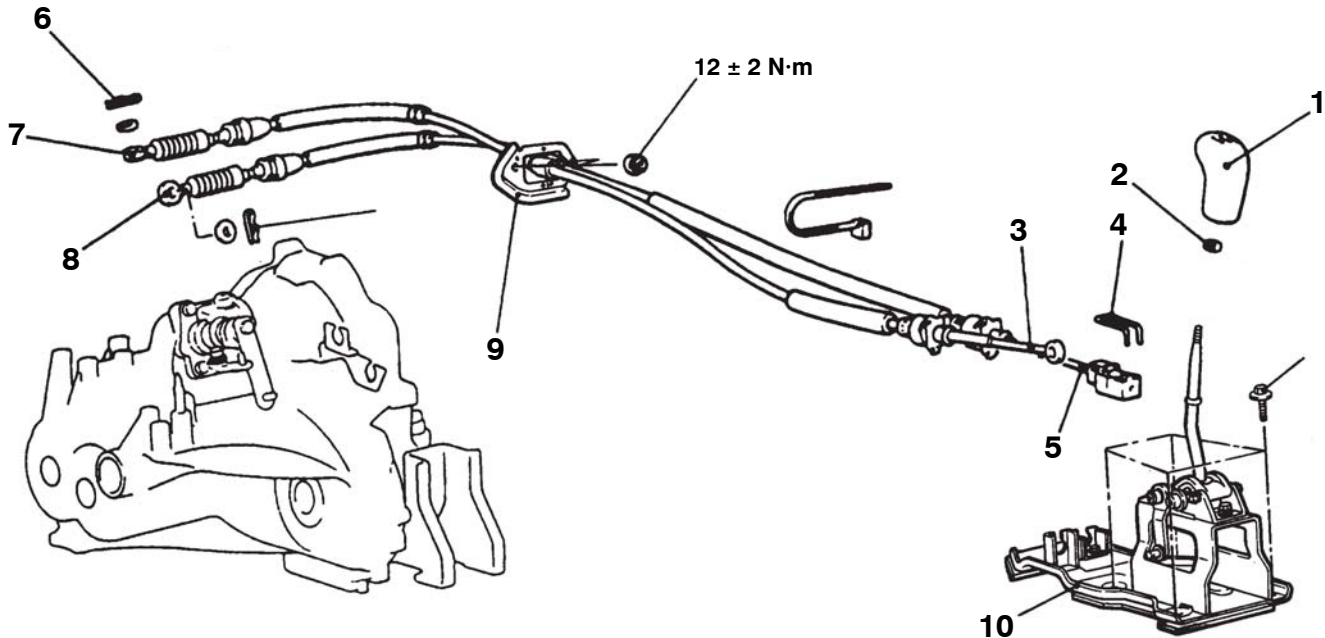

09DB020A

TRANSMISSION CONTROL CABLE ASSEMBLY REMOVAL STEPS

- >>B<< 1. Shift knob
>>B<< 2. Sleeve
Front floor console (Refer Group 52A.)
3. Select cable connection (shift lever side)
4. Clip
>>C<< 5. Shift cable connection (Shift lever side)
6. R-clip
>>A<< 7. Select cable connection (Transmission side)

- >>A<< 8. Shift cable connection (Transmission side)
>>A<< 9. Shift cable and select cable assembly

SHIFT LEVER ASSEMBLY REMOVAL STEPS

- >>B<< 1. Shift knob
>>B<< 2. Sleeve
Front floor console (Refer Group 52A.)
3. Select cable connection (shift lever side)
4. Clip
>>C<< 5. Shift cable connection (Shift lever side)
10. Shift lever assembly

INSTALLATION SERVICE POINTS

>>A<< SHIFT CABLE AND SELECT CABLE ASSEMBLY/ SHIFT CABLE CONNECTION/SELECT CABLE CONNEC- TION

1. Ensure the shift cable and select lever assembly is mounted in the vehicle with the "UP" symbol and arrow on the mounting plate pointing upward as shown in the illustration.

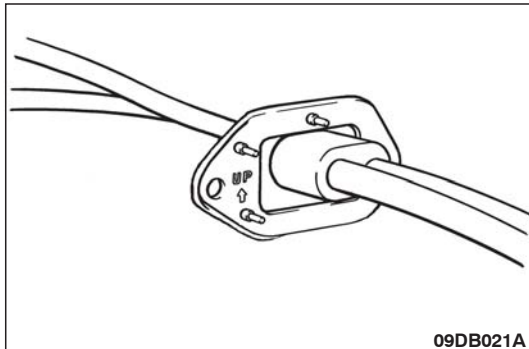

2. Set the transmission side shift lever and the passenger compartment side shift lever to neutral position.

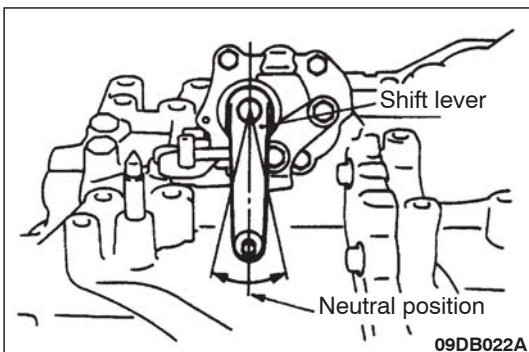

3. Fit "U"clip to transmission shift cable bracket securely (feel click). Then fit cable assembly into bracket securely (feel click).

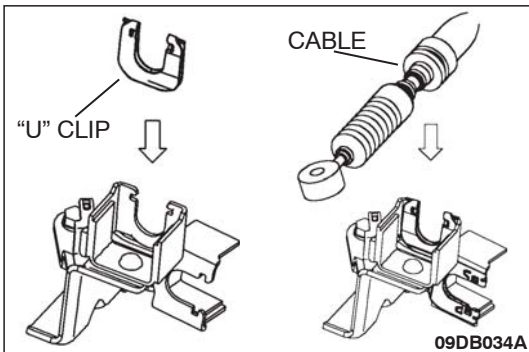

4. Install the shift and select cable ends onto transmission side lever pins, fit washers and snap pins.
5. Move the shift lever to all positions and check that the operation is smooth.

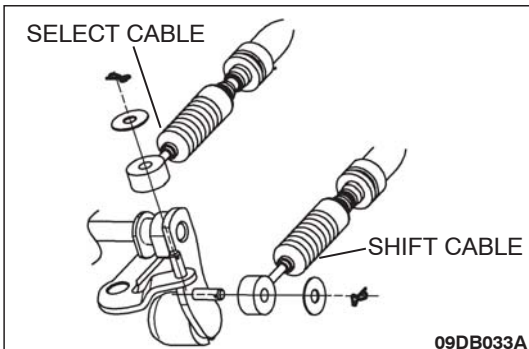

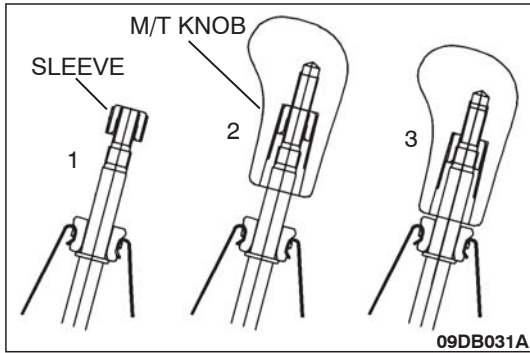

>>B<< SLEEVE SHIFT KNOB

1. Instal the sleeve onto tip of lever assembly.
2. Fit M/T Knob onto lever assembly.
3. Screw M/T Knob onto lever , initially 7 turns and then add 4 turns with knob aligned in correct direction for shift pattern.

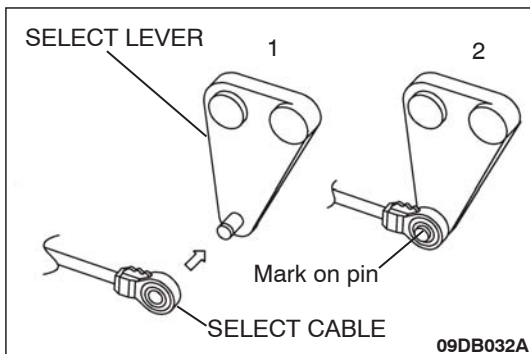

>>C<< SELECT CABLE FITMENT

1. Select cable is a "snap" fit onto lever pin.
2. Align cable eye with lever pin and push on firmly, ensuring cable is secured and lever pin marking is visible.

TRANSMISSION ASSEMBLY

REMOVAL AND INSTALLATION

Pre-removal Operation

- Transmission Oil Draining (Refer to On-Vehicle Service)
- Air Cleaner Removal (Refer to GROUP 15, Air Cleaner 15-4).
- Battery and Battery Tray Removal
- Under Cover Removal

Post-installation Operation

- Battery and Battery Tray Installation
- Air Cleaner Installation (Refer to GROUP 15, Air Cleaner 15-4).
- Under Cover Installation
- Supplying Transmission Oil (Refer to On-Vehicle Service)
- Shift Lever Operation Check
- Speedometer Operation Check

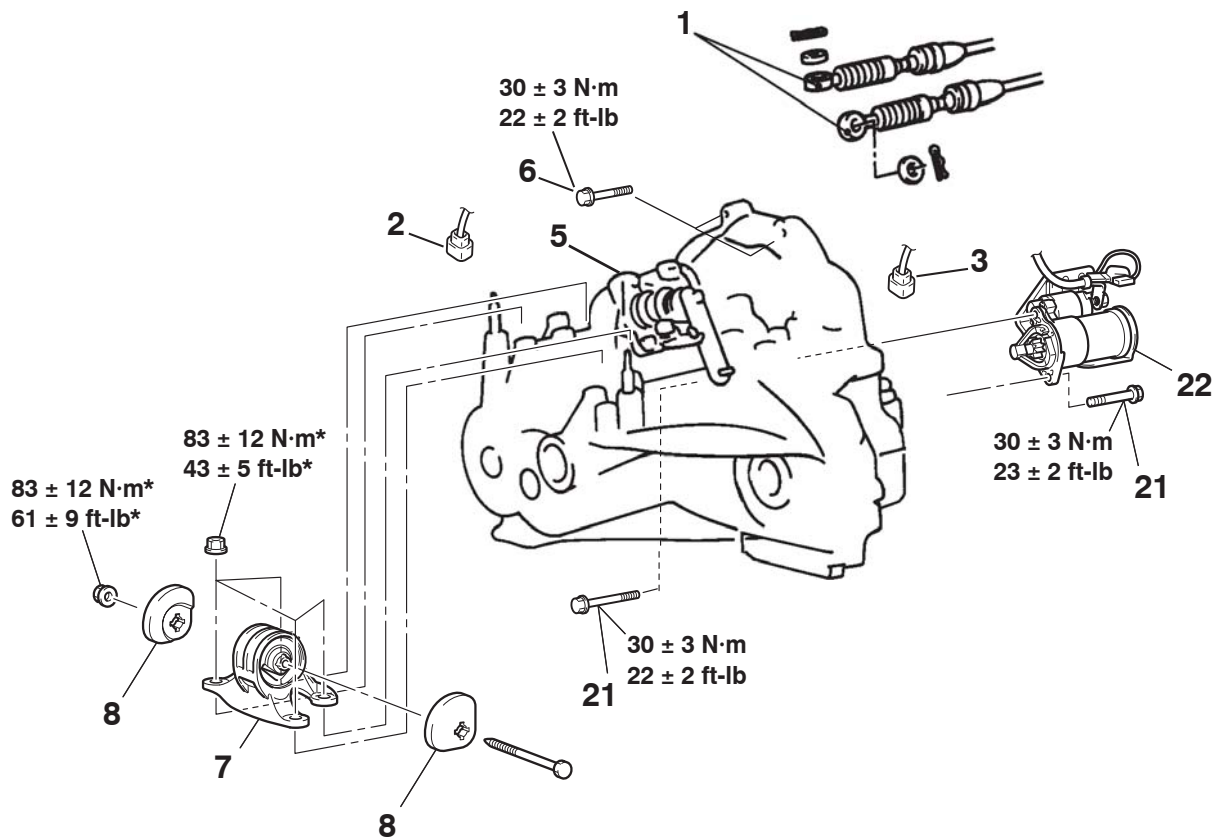

09DB023A

REMOVAL STEPS

1. Shift cable and select cable connection (Refer On-Vehicle Service)
2. Reverse lamp switch connector
3. Vehicle speed sensor connector
4. Starter motor
5. Clutch release cylinder

REMOVAL STEPS

6. Disengage clutch release bearing
7. Transmission assembly upper part coupling bolts
8. Transmission mount bracket
9. Transmission mount stopper
10. Supporting engine assembly

<<A>>

<>

<<C>>

<<D>>

>>A<<

<<E>>



1. Remove the starter motor form transmission with the harness still connected and secure it in position on top of exhaust manifold.

<> CLUTCH RELEASE CYLINDER

1. Remove the clutch release cylinder without disconnecting the fluid line and secure to vehicle chassis.

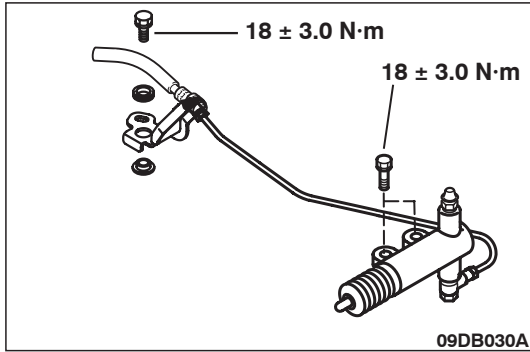

<<C>> RELEASE BEARING

1. Remove the access hole covers from the top and bottom of the clutch housing.
2. Push the clutch cylinder end of the release fork so that the release bearing pushes against the diaphragm spring.

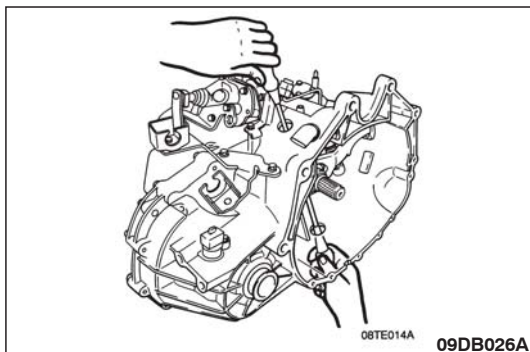
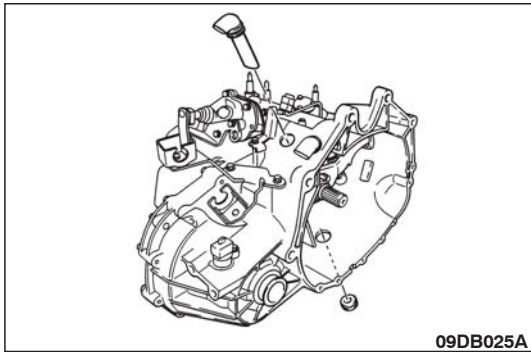

3. Insert a flat blade screwdriver in both top and bottom access hole in the clutch housing, between the release bearing and the diaphragm spring. Simultaneously turn both screwdrivers through 90 to disengage the release bearing.

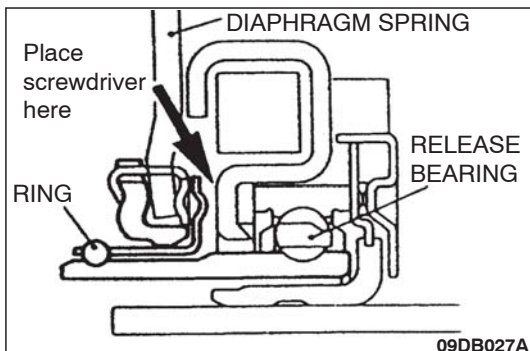

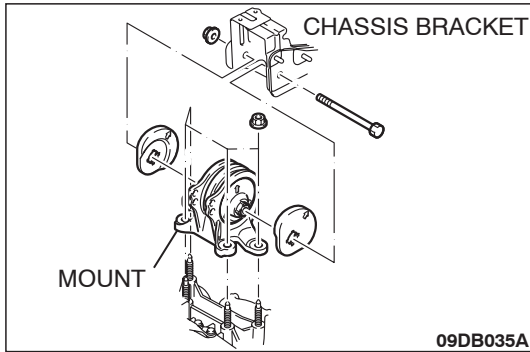
**<<D>> TRANSMISSION MOUNT BRACKET**

1. Jack up the transmission assembly gently with garage jack and then remove the transmission mount bracket through bolt. Mount assembly remains attached to transmission until removed from vehicle.

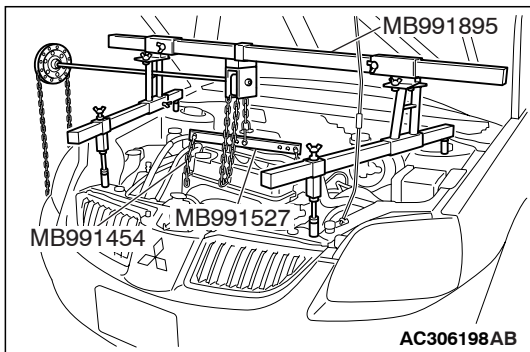
**<<E>> ENGINE ASSEMBLY SUPPORTING**

1. Set up the special tool to the vehicle to support the engine assembly.

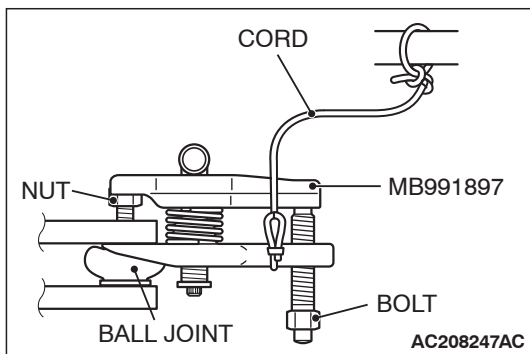
**<<F>> TIE ROD END/LOWER ARM BALL JOINT REMOVAL**

1. Set up the special tool to the vehicle to support the engine assembly.

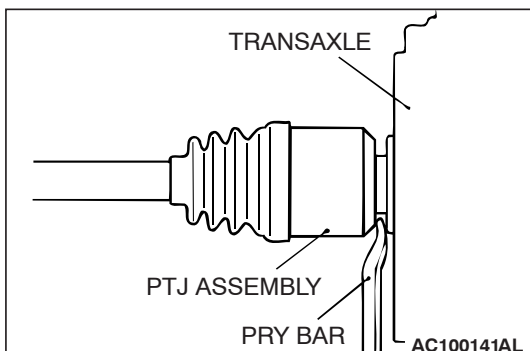
**<<G>> DRIVE SHAFT REMOVAL**

1. Insert a pry bar between the transmission case and the drive shaft to remove the shaft from transmission housing.

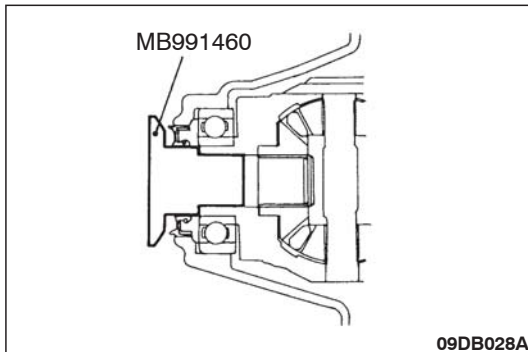

2. To prevent foreign material from entering the transmission case, insert a suitable plug into the drive shaft openings.
3. Suspend the RH drive shaft with wire so that there are no sharp bends in any of the joints.

INSTALLATION SERVICE POINT

>>A<< TRANSMISSION MOUNT STOPPER INSTALLATION

1. Install the transmission mount stopper so that the arrow points upward as shown in illustration. Ensure stoppers are installed onto mount correctly prior to fitment and do not dislodge during transmission installation.

